

FLAMENCA

VILLAGETM

| | |
|-----|---|
| 51 | PISCINA ADULTOS CLIMATIZADA / PISCINE CLIMATISÉE POUR ADULTES / HEATED ADULT'S POOL |
| 52 | PISCINA ADULTOS / PISCINE POUR ADULTES / ADULT'S POOL |
| 54 | GIMNASIO / GYM / GYM |
| 57 | ZONA DE TUMRONAS / ZONE DE CHAISES LONGUES / SLURFED |
| 65 | JUEGOS INFANTILES / JEUX D'ENFANTS / CHILDREN'S POOL |
| 66 | ENTRADA / ENTRÉE / ENTRANCE |
| 67 | ENTRADA APARCAMIENTO / ENTRÉE DE PARKING / PARKING ENTRANCE |
| 72 | ZONA VERDE PÚBLICA / ESPACE VERT PUBLIC / PUBLIC GREEN AREA |
| 73 | SAUNA / SAUNA / SAUNA |
| 74 | JACUZZIS CLIMATIZADOS / JACUZZI CHAUFFÉS / HEATED WHIRLPOOLS |
| 75 | ASEOS / TOILETTES / TOILETS |
| 77 | OFICINA TM / BUREAU TM / TM OFFICE |
| 78 | BUZONES / BOITE AUX LETTRES / MAILBOX |
| 80 | CHILL OUT / CHILL OUT / CHILL OUT |
| 81 | SALIDA APARCAMIENTO / SORTIE DE PARKING / PARKING EXIT |
| 82 | FUENTE / FOUNTAIN / FOUNTAIN |
| 90 | DUCHAS / DOUCHES / SHOWERS |
| 96 | PARKING EXTERIOR / EXTERIEUR PARKING / EXTERIOR PARKING |
| 104 | LOCALES COMERCIALES / LOCAL COMMERCIAL / BUSINESS PREMISES |
| 117 | JUEGOS INFANTILES DE AGUA / JEUX D'ENFANTS D'EAU / CHILDREN'S WATER PLAY AREA |
| 118 | PISCINA INFANTIL CLIMATIZADA / PISCINE D'ENFANTS CLIMATISÉE / HEATD CHILDREN'S POOL |



Van Dam Estates

FLAMENCA

VILLAGE

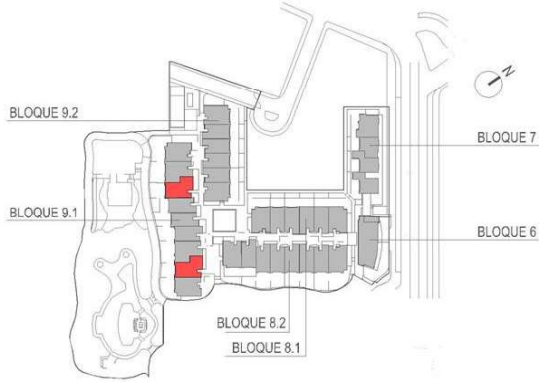

| nº | SUPERFICIES ÚTILES / FLOOR AREA / SURFACES UTILES | TIPO TYPE TYPE LL2a |
|--|--|------------------------|
| 1 | VESTIBULO / HALL / ENTRÉ | 3,91 m ² |
| 2 | PASO 1 / CORRIDOR 1 / CIRCULATION 1 | 3,66 m ² |
| 6 | COCINA / KITCHEN / CUISINE | 6,62 m ² |
| 7 | GALERÍA / GALLERY / GALLERIE | 2,44 m ² |
| 8 | SALÓN COMEDOR / LIVING-DINING ROOM / SALON-SALLE A MANGER | 22,43 m ² |
| 9 | DORMITORIO 1 / BEDROOM 1 / CHAMBRE 1 | 13,55 m ² |
| 10 | DORMITORIO 2 / BEDROOM 2 / CHAMBRE 2 | 9,80 m ² |
| 11 | DORMITORIO 3 / BEDROOM 3 / CHAMBRE 3 | 9,53 m ² |
| 12 | BAÑO 1 / BATHROOM 1 / SALLE DE BAINS 1 | 4,08 m ² |
| 13 | BAÑO 2 / BATHROOM 2 / SALLE DE BAINS 2 | 4,08 m ² |
| 14 | TRASTERO / STOREROOM / CAVE | 4,38 m ² |
| 32 | ZAPATERO / SHOE LOCKER / PLACARD À CHAUSSURES | 0,52 m ² |
| TOTAL SUP. ÚTILES / TOTAL FLOOR AREA / TOTAL SURFACES UTILES | | 85,20 m ² |
| SUP CONSTRUIDA INTERIOR / BUILT INTERIOR AREA / SURFACE CONSTRUITE INTÉRIEUR | | 99,08 m ² |
| 18 | SUP CONSTRUIDA DE TERRAZA / BUILT TERRACE AREA / SURFACE CONSTRUITE TERRASSE | 20,02 m ² |
| TOTAL SUP.CONSTRUIDA PRIVADA / TOTAL BUILT PRIVATE AREA / TOTAL SURFACE CONSTRUITE PRIVATIVE | | 119,10 m ² |



TIPO/TYPE **LL2a**

Apartment, 3 Bedrooms + 2 Bathrooms - Second Floor